

Horatio Street, Manhattan, N.Y., USA

This luxury condominium had only recently been completed when it was discovered that a gradual separation was developing between the 8 inch (203mm) concrete plank flooring and the vertical walls upon which they rested. The threat of demolition was very real. A solution, however, was found by the installation of 709 Cintec Anchors to maintain the building's structural integrity.

Drilled into the concrete flooring, each anchor was fitted with a 16 x 3.3 inch (400 x 83mm) front plate attachment. This locked the flooring back against the supporting wall. Outer brick-work was then replaced to fully conceal the work.



section at wall intersection

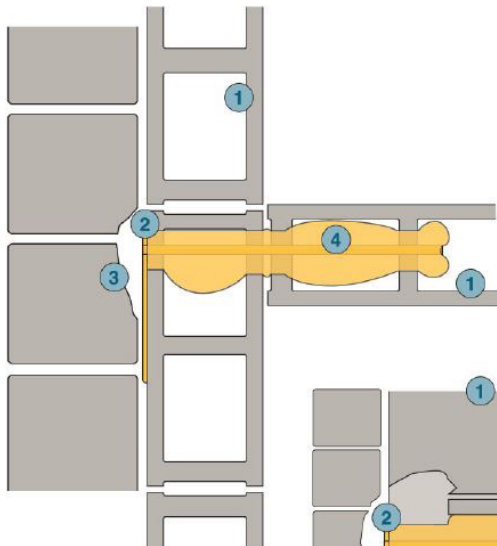

wall section at plank bearing

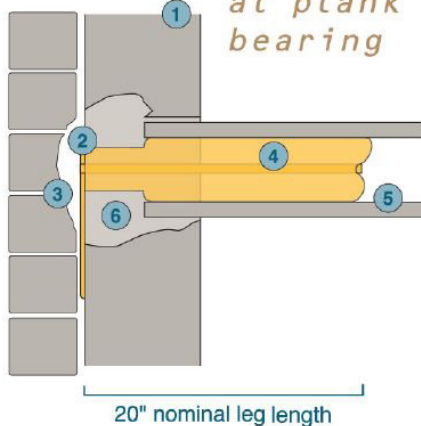

- ① existing hollow block wall
- ② 16 x 3 1/2 x 1/2" plate welded to 1" threaded bar
- ③ face brick to be removed and replaced, masonry locally cut back where necessary to install anchor
- ④ 1" diameter Cintec stainless steel anchor
- ⑤ existing 8" concrete plank
- ⑥ temporary plywood form work to be used and removed before anchor installation